



Sales and Services Network

# 切削刀具及专用砂轮

Cutting Blades & Knives with Grinding Wheels

[www.HeroHome.com.cn](http://www.HeroHome.com.cn)

中国·西安市英隆超硬材料厂

地址：中国·陕西省西安市临潼区现代工业园区  
电话：029-63354776/62821158/83851636  
传真：029-62821168/83852230  
邮编：710600  
网址：[Http://www.HeroHome.com.cn](http://www.HeroHome.com.cn)  
[Http://www.cnHeroHome.com](http://www.cnHeroHome.com)  
邮箱：[sales@cnHeroHome.com](mailto:sales@cnHeroHome.com)  
[cnHeroHome@Gmail.com](mailto:cnHeroHome@Gmail.com)

YingLong(HeroHome) SuperHard Materials ManuFactory

Address: Modern Industrial Zone, Lintong Dist., Xi'An, CHINA  
Phone: +86-29-63354776/62821158/83851636  
Fax: +86-29-62821168/83852230  
Website: [Http://www.HeroHome.com.cn](http://www.HeroHome.com.cn)  
[Http://www.cnHeroHome.com](http://www.cnHeroHome.com)  
E-mail: [sales@cnHeroHome.com](mailto:sales@cnHeroHome.com)  
[cnHeroHome@Gmail.com](mailto:cnHeroHome@Gmail.com)

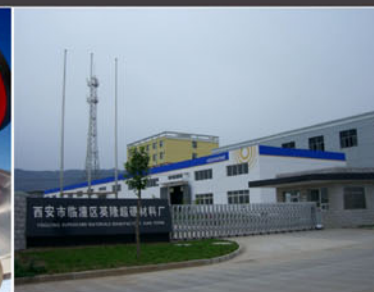

[www.HeroHome.com.cn](http://www.HeroHome.com.cn)

Cutting & Abrasive Tools

西安市英隆超硬材料厂

YINGLONG SUPERHARD MATERIALS MANUFACTORY

## 公司简介 COMPANY PROFILE

西安市临潼区英隆超硬材料厂位于陕西省西安市临潼区现代工业园区内，紧临著名的世界第八大奇迹——秦始皇兵马俑博物院，是我国重要的超硬材料及相关制品的主要生产基地。它是集新技术与产品开发、研究制造、经营销售为一体，有着三十余年专业生产经验的超硬材料及制品的生产企业。主要产品包括普通材料及超硬材料砂轮与其它磨具，各类硬质合金、高速钢、合金钢、工具钢材质的常规及异形刀具共两大类系列上百个品种，三千余种规格。并可根据各类非常规产品需求设计与定制生产。

本厂设备齐全、技术力量雄厚、拥有十多名国家级专业工程师掌控技术研发及产品生产各道工序。曾数次成功研制生产出可完全替代进口产品的磨料磨具及切削刀具制品，为国家节省了大量的外汇，并赢得了广大客户的认可。产品远销欧美、东南亚、中东等世界各国与地区。

英隆人将继续秉承和发扬一贯的“标准始于精工，服务来自真诚”的企业理念，与国内外的新老客户、同行及朋友们共同发展。我们热情期盼您的惠顾，感谢您的大力支持！

Located in the Modern Industrial Zone of Lintong Dist., Xi'An, ShaanXi, CHINA. Our Enterprise - YingLong(HeroHome) SuperHard Materials ManuFactory is One of the Most Important Primary Production Bases of SuperHard Materials and Related Cutting & Grinding Tools With the World-Famous Terra-Cotta Museum Besides it.

YingLong(HeroHome) is a Professional Company with Over 30 Years of Experiences in Manufacturing, Sales, Marketing and the R&D of New Technologies & Products. Our Main Products Include Two Series of Diamond/CBN Grinding-Wheels with Other Abrasive Tools; Tungsten Carbide/High Speed Steel (HSS)/Alloy Steel/Chrome Steel with Over Hundreds of Types and More than Three Thousands Patterns. Meanwhile We Can Design and Specifcily Manufacture & Process Products According to Irregular Patterns and Special Requirements of Our Customers.

We Have Built Our World-class Reputations With Our Clients As We Have the Most Modernized & Sophisticated Machinery and State-of-the-art Technology. In Addition, We Have Twelve National-Level Professional Engineers Who Control Every Phase of the R&D and the Processes of Manufacture and Quality-Control.

YingLong Has Successfully Developed Several Abrasive & Cutting Tools those can be Competitive With High-quality of Imported Products, Leading to Considerable Costs-Saving for Our Country and Our Customers. Meanwhile We Won the Widely Acknowledgements of the Customers Around the World. Nowadays Our Products Are Exported to the Nations and Districts All Around the World as Europe, America, Mid and Southeast Asia, Pacific Regions, Canada and Australia as well as Africa etc.

We Will Continue to Hold as Our Motto **"High Standards, Excellent Customer Services"** for All the Time, and We Are Working to Achieve a Mutually Beneficial Relationship With New & Old Clients Around the World. We Sincerely Hope for Your Attentions, and Many Thanks for Your Greatest Supports for All the Time to YingLong(HeroHome)!

英隆产品被广泛应用于包装、航天、纤维制造、机械、汽车、电子工业、精密加工等多个领域。

Our Grinding & Cutting Products are Widely Applied in Many Fields.  
As Packaging, Tissue-Converting, Machining, Automobile, Precision Process etc.





# YINGLONG SUPERHARD MATERIALS MANUFACTORY

## CUTTER BLADES & KNIVES IN TISSUE-PAPER CONVERTING

### BLADES & KNIVES



**HEROHOME**  
*to be Your Hero*

"HeroHome" is One of the Leading Manufacturers and Suppliers for Cutter Blades & Knives, Especially Applied in Tissue-Paper Converting Machinery. We Manufacture Typical Models Serve for Machines as Perini, PCMC, Futura, Bretting, Echo, Ital Converting etc. around the World.

Our Blades & Knives Applied in Tissue-Paper Converting Includes:

**I. Log Saw Blades** are Made in the Materials of HSS(High Speed Steel)/Alloy Steel/Chrome Steel/Tool Steel/Tungsten Carbide and so on.

With Different Precisely Heat Treatment, Our Log Saw Blade with Hardened Hardness to Increase the Wear-Resistance and the Heat-Deformation had Proved of High Performances while Cutting Toilet Rolls.

The Regular Diameter is Up-to OD610mm, OD510mm, OD400mm etc. Our Log Saw Blades could be Produced as Specifically as per the Customers' Requirements for Different Models and Materials.

**II. Perforation Blades & Anvil Blades** Could be Made in HSS(High Speed Steel)/Alloy Steel/Chrome Steel/Tool Steel and so on.

We Could Provide These Kinds of Blades with Dozens of Models & Patterns, such as L3500mm, L3000mm, L2950mm, L2800mm, L2500mm etc., it Could also be Produced as Specifically as per the Customers' Requirements for Different Models and Materials.

**III. Top Slitter & Bottom Slitter** Needs to be Used as a Suite. They Could be Made in Materials of HSS(High Speed Steel)/Alloy Steel/Chrome Steel/Tool Steel and Tungsten Carbide etc.

The Diameters of Top Slitters Range from OD75mm, OD105mm, OD140mm, OD150mm, OD180mm etc. And Bottom Slitter Normally Has OD100mm, OD110mm, OD188mm etc.; Also, Specific Models & Patterns Could be Produced by Clients' Specifically Requirements.

**IV. Other Irregular & Non-Standard Cutting Blades & Knives** Could be Produced as Specifically as per Customers' Exact Requirements.

Besides the Cutting Blades & Knives in Tissue-Paper Industry, "HeroHome" Serves our Customers Widely in the Different Fields of Packaging & Printing, Cigarettes, Tapes, Leather, Food & Meat etc. in Various Patterns/Models & Material for Clients to Choose.

### ADVANTAGES

With Senior Experiences & Unique Formula, We Could Offer the Blades & Knives with Higher Grinding Efficiency & Longer Duration Life-Time; With Total Control & the Most Familiar to the Processes of Grinding & Sharpening, as We are also a Professional Manufactory of Grinding Wheels, Thus our Blades & Knives would be Matched with Perfect Finishing and the Lowest Costs at this Part.

This Helps Our Cutters to be the Most Convincing Products in the Market by Obvious Advantages in Both Performances & the Costs.

We Successfully Prompted our Blades with Various Patterns and Models Around the World. By the Significant Performances in Quality + Services + Offers, We Had Won Great Reputations among Our Customers in the Whold Wide World.



Generated With Over 30 Years of Production Experiences, "HeroHome" is Capable to Provide the Best Quality & the Most Competitive Prices to Every Honorable Customer, and We are Capable to Solve All the Technical Questions & Enquiries from our Clients Directly. Under Our Motto as Always:

**High Standards, Excellent Customer Services.**

We All would Spare Every Effort to Offer the Best Services & the Most Satisfiable Products to All the Respectful Customers.

### CONTACT US

**YingLong(HeroHome) SuperHard Materials ManuFactory**

Address: Modern Industrial Zone, LinTong District, Xi'An, CHINA.

Fax: +86-29-62821168/63354775 ZIP Code: 710600

Phone: +86-29-62821158/63354776 Cell: +86-(0)135-7245-1944

Email: Export@cnHeroHome.com HeroHome.Export@Gmail.com

Web: <http://www.HeroHome.com.cn/>

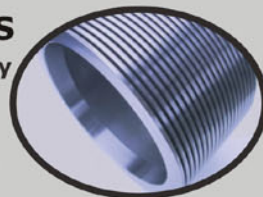

# YINGLONG SUPERHARD MATERIALS MANUFACTORY

## CUTTER BLADES & KNIVES IN TISSUE-PAPER CONVERTING

MAIN  
PRODUCTS

### VARIOUS BLADES AND KNIVES FOR TISSUE PAPER CONVERTING INDUSTRY(mm)

Description	Material	Length	Width	Thickness	Application
		L	W	T	
(A) Perforation Blade (With Teeth)	HSS (High Speed Steel), Alloy Steel, Chrome Steel, Tool Steel, Tugsten Carbide	400	26	3	Making Delicate Perforations on the Base Paper; Blades with Teeth and Without Teeth Must be Used as a Suite
		445	35	2	
		1800	35	1.25	
		2000	50	1.5	
		2500	35	1.25	
(A) Perforation Blade (Without Teeth)	Steel, Chrome Steel, Tool Steel, Tugsten Carbide	1000	35	1.5	
		1300	35	1.5	
		1900	35	1.5	
		2000	30	1.5	
		2500	35	1.25	
		2800	50	1.5	

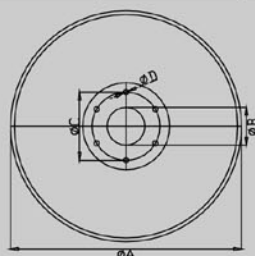
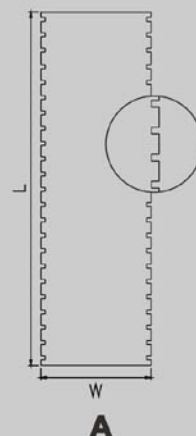

B-1

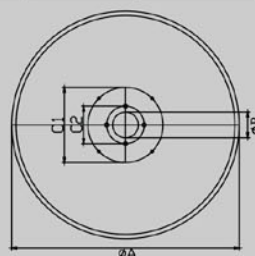

B-2

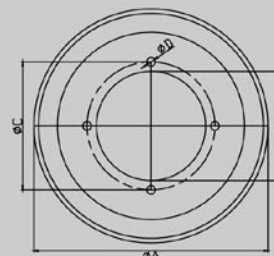

B-3

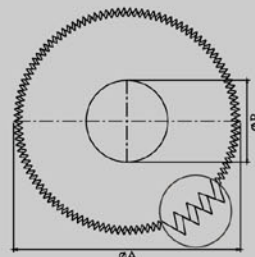

C

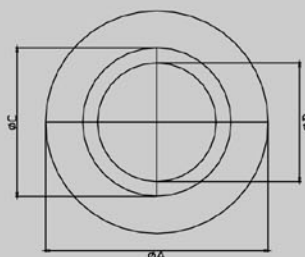

D-1

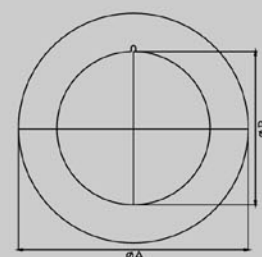

D-2

Description	Material	Outer Diameter	Hole Diameter	Thickness	Application
		ΦA	ΦB	T	
(B) Log Saw Blade	HSS(High Speed Steel), Alloy Steel, Chrome Steel, Tool Steel, Tugsten Carbide	610	68.26	4.76	Used for Cutting Tissue Paper Roll
		610	68.26	3.5	
		610	82.55	4.76	
		610	100	4.76	
		610	100	3.8	
(C) Saw Blade		150	54	0.6	
(D) Top Sitter	HSS(High Speed Steel), Alloy Steel, Chrome Steel, Tool Steel, Tugsten Carbide	105	70	1.2	Cutting and Detaching Base Paper, Top and Bottom Slitter Must be Used as a Suite
		130	70	1.5	
		140	70	1.5	
		150	80	2.2	
		180	70	2.5	
(D) Bottom Slitter		100	80	10	
		110	65	10	
		188	148	110	
		250	200	160	



# YINGLONG SUPERHARD MATERIALS MANUFACTORY GRINDING WHEELS IN TISSUE-PAPER CONVERTING

MAIN

PRODUCTS

## INTRODUCTION

"HeroHome" Manufactures CBN(Cubic Boron Nitride) & Diamond Grinding Wheels in Tissue-Paper Converting Industry, Specifically for the Sharpening of Cutting Knives & Blades. Such as **Log Saw Blades**, **Top Slitting Blades** etc. made in Materials of **HSS(High Speed Steel)**, **Alloy Steel**, **Chrome Steel** & **Tungsten Carbide**, these Cutters are after Precisely Heat-Treated to Achieve a Final Hardness of Rockwell 57-65 with Excellent Cutting Longevity and Wear-Resistance.

"HeroHome" Produces the Most Suitable CBN & Diamond Grinding Wheels for the Cutters in Tissue-Paper Converting Industry.



## INFORMATION

Certain Issues for Choosing a Suitable Grinding Wheel:

**I. Choice of Abrasive:** CBN(Cubic Boron Nitride) is a Kind of Synthetic Super-Hard Materials, the Second Hardest Material in the World. Its Hardness only Inferior to the Synthetic Diamond.

It not only owes the Major Properties of Diamond, but also it Has a Higher Thermal Stability with Iron-Metal Group, the Obvious Advantages of CBN Abrasives are in the Processing of the Materials such as HSS(High Speed Steel), Alloy Steel, Chrome Steel, Tool Steel and those Steels with Hardness between Rockwell 45-68.

**II. Choice of Grain Size:** Grain Size Refers to the Size of Abrasive-Grains, it is Extremely Related with the Grinding Efficiency and the Surface Finishing Degrees of the Grinded-Items.

Generally Speaking, More Coarse Grain Size brings Higher Grinding Efficiency, while the Surface Finishing Degree would be Relatively Lower, and Vice Versa.

To Sharpen the Log Saw Blades, FEPA Standard Grain Size B107 (same as ISO Standard 140/170#) would be the Most Suitable Choice. This Grain Size Has been Proved to be the Perfect Match for Log Saw Blades after a Long-Time Explorations & Practical Experiences. And Grain Size D107 Refers that the Same Size but in Diamond Abrasives.

**III. Bond or Binder:** it Refers to the Material Applied for Binding the Grains during the Production of Abrasive Tools. The Most Common Binders includes Resin, Metal, Vitrified & Electro-Plated Binder.

For Sharpening of Log Saw Blades, Resin Binder is the Most Suitable Choice by its Significant Performances of Self-Sharpness to Grind the Blades by the Shortest Grinding Time, Longer Duration-Time of Using and the Guaranteed Sharpening Results of Blades.

**IV. New Trends:** For Super-Hard Grinding Wheels in Tissue-Paper Converting Industry, Diamond Material would be Applied Gradually in the Future for the Aim of Meeting the Industrial Developments.

End-Users are Seeking Higher Cutting & Grinding Efficiency With Lower Consuming Costs, Gradually They would Like to Use Tungsten Carbide Blades and Slitters due to the Longest Duration. The Diamond Grinding Wheels are with Obvious Advantages for Sharpening Tungsten Carbide Cutters.



## IMPRESSION

With Adopt of Top-Class Stable Raw-Materials & Senior Engineers Strictly Control the Overall Production Processes to Ensure the Highest Quality of Our Products, "HeroHome" could Produce and Supply the Most Suitable Grinding Wheels for Various Blades and Knives. The Combinations of the Grinders with the Cutters Both Made by "HeroHome" would be Your Best Choice!

**HEROHOME**  
to be Your Hero

## CONTACT US

**YingLong(HeroHome) SuperHard Materials ManuFactory**

Address: Modern Industrial Zone, LinTong District, Xi'An, CHINA.

Fax: +86-29-62821168/63354775 ZIP Code: 710600

Phone: +86-29-62821158/63354776 Cell: +86-(0)135-7245-1944

Email: Export@cnHeroHome.com HeroHome.Export@Gmail.com

Web: Http://www.HeroHome.com.cn/ Http://www.cnHeroHome.com/



# YINGLONG SUPERHARD MATERIALS MANUFACTORY

## GRINDING WHEELS IN TISSUE-PAPER CONVERTING

### CBN/DIAMOND GRINDING WHEELS FOR TISSUE-PAPER CONVERTING INDUSTRY

P - Profile View; T - Top View

MAIN

PRODUCTS

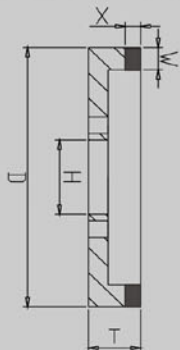

6A2(A)-P

WHEEL SHAPE	Description(mm)	Location Hole	Slots	Technique Data
6A2(A)	D70xT13.5xH20xW5xX4	4	N/G	Abrasive: CBN Grain Size: FEPA-B107 (140/170#) Bond: Resin C100%
	D70xT13.5xH20xW6xX4	4	N/G	
	D100xT16xH20xW5xX3	4	N/G	
6A2(B)	D100xT16xH20xW6xX4	3	4	
	D100xT16xH20xW7xX3	3	4	
12A3	D125xT43.7xH32xW10xX2	N/G	N/G	

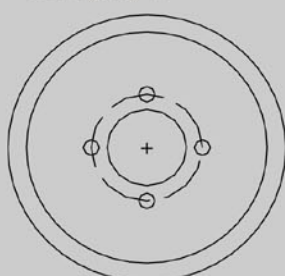

6A2(A)-T

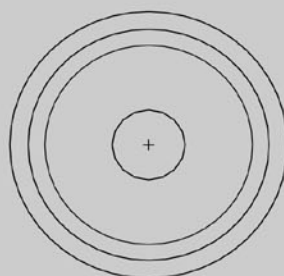

12A3-T

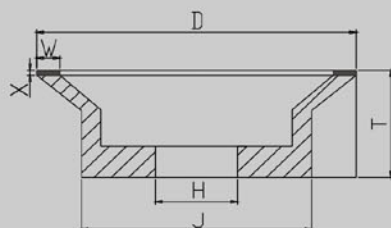

12A3-P

WHEEL SHAPE	Description(mm)	Abrasive	Grain Size	Bond	Application
12A2	D150xT20xH31.75xW6xX4	CBN C100%	FEPA-B107 (140/170#)	Resin	Sharpening the Log Saw Blades in HSS, Alloy Steel, Chrome Steel, Tool Steel etc.
	D150xT20xH31.75xW5xX4				
	D150xT20xH31.75xW3xX4				
9A3	D150xT20xH31.75xW10xX3				
	D150xT19xH31.75xW6xX2				

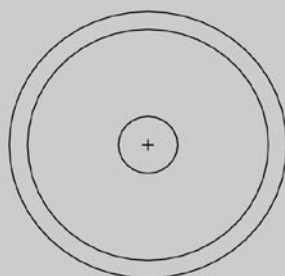

9A3-T

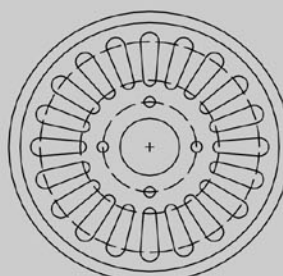

12A2-T

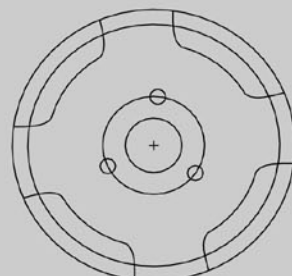

6A2(B)-T

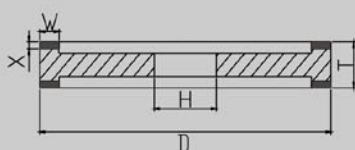

9A3-P

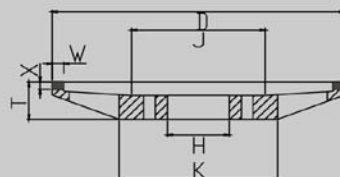

12A2-P

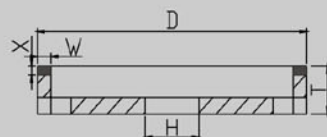

6A2(B)-P