

YINGLONG SUPERHARD MATERIALS MANUFACTORY

BLADES & KNIVES

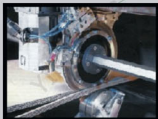

We Manufacture Cutting Blades & Knives Widely Applied in Many Fields:

- 1, Slitter Scorer Thin Cutter Blades & Knives in Materials of High Speed Steel(HSS)/Tungsten Carbide(YGB)/Chrome Steel/Tools Steel etc.;
- 2, Transversal Cutter & Helical Cutter in Materials of HSS/Solid Carbide/Tungsten Carbide Coated/Chrome Steel/Tools Steel/Alloy Steel etc.;
- 3, Extreme-Large or Ultra-Small Cutters for Many Fields like Printer, Toilet Paper, Tyre, Office Equipments, Plastic Cutters and So on;
- 4, Other Irregular Custom Cutters By the Customers' Requests.

The Thin Cutter Blades & Knives Esp. for Slitter Scorer Machine in Corrugator is Highly Recommended. "YingLong" Possesses the Unique Skills & Technologies, As Well As Over 30 Years Experiences on Manufacturing, R&D of Blades and Knives. We Are Capable to Provide the Best Qualities with the Most Competitive Prices to Our Honorable Customers Around the World.

ADVANTAGES

Since We Had Built, We Successfully Prompted and Marketed of Our Thin Cutter Blades & Knives in Various Materials & Advanced Formulae to the Whole World. We Had Won Great Reputations Around Our Customers By Our Performances. "YingLong" Blades & Knives Have Been Exported to Over 50 Countries with Over 10 Years' Export Experiences. Esp. our HSS /Solid Carbide Slitter Scorer Cutting Blades Had Been Acknowledged Highly By Its Cutting Efficiency & Long Life-time By All the Customers. "YingLong" Cutters Possesses the Following Advanced Merits:



- * Totally Control & Familiar to the Processes of Grinding/Polishing. We Are a Manufacturer of Grinding Wheels, So Our Blades & Knives Totally Under Strict & Perfect Grinding/Polishing Processes. Which Makes Our Products in Much Better Granularity & Finishing Degree, That Will Largely Improve the Performances Much in Nature of Cutting Sharpness Which is the Keypoint of the Quality for Cutters;
- * Historical Exp. on Manufacturing & Technologies. Over 30 Years Exp. On Manufacturing Grinding & Cutting Products. So We Are Totally Capable to Control All the Phases for Production and to Solve Most Technical Problems of Our Customers Directly;
- * We Focused on the Nature Itself, So Our Materials Include More Vital Parts Such As More Cobalt & Other Nobel Metals Percentages; As Well As Vital Technicals like Twice Burning>Returns, and More Processes of High-Temperature Isostatic Pressing with Much Finer Grit Sizes etc. Those Can Largely Increase Our Knives & Blades' Cutting Performances With Using Stabilities, Meanwhile the Usage Life-time is Prolonged to the Biggest Scale Compares With Others;
- * Costs Saving Leads to the Most Favorite Prices. We Have Our Unique Formulae & Exp. to Save Much More Costs. So the Prices Are Always Be the Most Competitive on International Markets. It Can Compete Definitely with Big Suppliers While the Offers Are Much Favorite.



CONTACT US

YingLong(HeroHome) SuperHard Materials ManuFactory
Add: Modern Industrial Zone, LinTong Dist., XiAn, CHINA
Fax: +86-29-62821168/83852230 Code: 710600

General Office:

Phone: +86-29-83851636 Email --- Info@cnHeroHome.com

Commercial Department:

Phone: +86-29-62821168 Email --- Sales@cnHeroHome.com

Export Department:

Phone: +86-29-62821158 Email --- Export@cnHeroHome.com

Technical Department:

Phone: +86-29-83855677 Email --- Tech@cnHeroHome.com



MAIN
PRODUCTS

YINGLONG SUPERHARD MATERIALS MANUFACTORY

CORRUGATED SLITTER KNIVES

Machine Types & Dimensions (MM)



HSIEH HSU



TCY



LATITUDE



MARQUIP

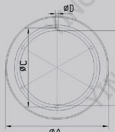

MITSUBISHI

Outer Diameter ϕA	Inner Diameter ϕB	Spots PCD ϕC	Spots Diameter ϕD	Knife Thickness (T)	Suitable For Machine TYPE
272	168	187.5	11	1.2	HSIEH HSU
260	168	187.5	11	1.2	
260	114	140	12	1.4	TCY
265	112	135	11	1.2	
300	112	135	11	1.1	
300	112	135	11	1.3	LATITUDE
258.9	168.35	E38	10.319	1.193	MARQUIP
240	32	100	8.5	1.2	BHS
250	150	R5	N/A	1.2	PETERS
250	150	R5	N/A	0.8	
280	202	217	7.5	1.4	MITSUBISHI
280	160.1	175	8	1.5	
291	130	203	8.7	1	FOSBER
230	110	130	9	1.1	
220	115	130	9	1	AGNATI
240	115	130	9	1.5	
260	175	N/A	N/A	1.5	ISOWA

Slitting Blades in Corrugated Line

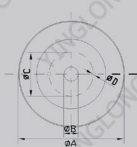

BHS



PETERS

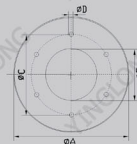

FOSBER



AGANATI

YINGLONG SUPERHARD MATERIALS MANUFACTORY

MAIN PRODUCTS

SPECIALTY

YingLong Grinding Wheels Possessed the Following Characteristics:

- 1, Adopted of SuperHard Abrasive-Materials of Synthetic Diamond & CBN(Cubic Boron Nitride), Which Can Satisfy All the Thin-Cutter Blades Grinding Requirements in the Materials of HSS(High Speed Steel) & Solid Carbide(YGB) & Also Other Metal Materials;
- 2, Resinoid Bond Which is the Most Suitable Binder to the Grinding of Thin-Cutters, It Will Keep the Excellent Grinding-Capability of the Grinding Wheels at Any Time Which is Vital to the Grinding Wheels;
- 3, Different Kinds of Granularities Suit to the Different Grindings Under Certain Materials and Situations: Coarse-Grinding in 80#-120#; Half-Coarse in 120#-180#; Fine-Grinding in 180#-W40; Polishing in W40-W0.5. The High Glabrous-Degree of the Tungsten Carbide with High Requirements to the Grinding of Blades, So It Suits for Grits Between 180# - W40; While the Cutter in HSS Suits in 150# - 230#;
- 4, Reasonable Collaborations of Grinding Wheels in Different Densities will Bring Lots of Merits For Instance Finer Grinding and Suitable Using for the Different Cutters.

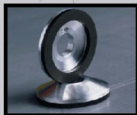

ADVANTAGES

- * Special-Used Grinding Wheels for Thin-Cutter Slitter Scorer Machine in Corrugated Carton Box Production Line, Includes Special Wheels for Tungsten Carbide Blades, HSS Blades & Grinding Wheels for Blades in Miscellaneous Materials;
- * Imported of Excellent & Stable Materials, Unique Formulae & Advanced Technologies Have Been Adopted in **YingLong** Grinding Wheels. Our Senior Engineers Strictly Control the Overall Production Processes for Ensuring the Qualities;
- * Featuring with Sharp Grinding & Excellent Weariness, Our Products Have Been Proved to Reach or Even Exceed the International Advanced Top Level. We Have Experienced and Skillful Technicians who Ensure that Both Precisions & Specifications of Every **YingLong** Wheel to Meet the International Standards for the Best Performances.

CONTACT US

YingLong(HeroHome) SuperHard Materials ManuFactory

Add: Modern Industrial Zone, LinTong Dist., XiAn, CHINA

Fax: +86-29-62821168/83852230

Code: 710600

General Office:

Phone: +86-29-83851636

Email --- Info@cnHeroHome.com Info@Grinding-Wheel.cn

Commercial Department:

Phone: +86-29-62821168

Email --- Sales@cnHeroHome.com YingLong@cnHeroHome.com

Export Department:

Phone: +86-29-62821158

Email --- Export@cnHeroHome.com CnHeroHome@Gmail.com

Technical Department:

Phone: +86-29-83855677

Email --- Tech@cnHeroHome.com YingLong@Grinding-Wheel.net

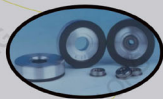

YINGLONG SUPERHARD MATERIALS MANUFACTORY

CORRUGATED

GRINDING WHEELS

Diamond/CBN Grinding-Wheels For Slitting Blades

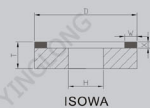
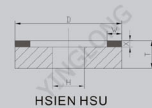
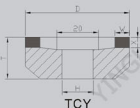
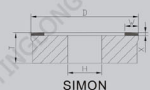
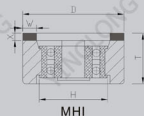
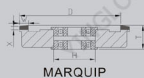
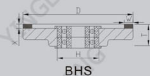
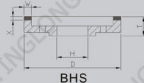
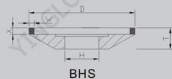

MACHINE TYPE	SPECIFICATIONS (mm)	MACHINE TYPE	SPECIFICATIONS (mm)
BHS	D50*T10*H16*W4*X2	JIAYOU	D50*T10*H16*W3.5*X3
	TWO SPOTS DRILLED	HUANQIU	D50*T10*H16*W3.5*X3
	D50*T10*H16*W2.5*X3	PETERS	D50*T10*H8*W3*X2
	D50*T10*H19*W4*X2	HSIEH HSU	D50*T13*H15*W7*X3
MARQUIP	D50*T12.6*H19*W6*X3	JINGSHAN	D50*T13*H15*W7*X3
	D50*T13.3*H6.35*W6*X1.5	CHAMPION	D50*T13*H15*W7*X3
FOSBER	D70*T13.5*H20*W6*X4	FULI	D50*T13*H15*W7*X3
	FOUR SPOTS EQUALLY DRILLED	TCY	D50*T20*H15*W7*X5
	D70*T13 *H20*W6*X3		
MITSUBISHI	FOUR SPOTS EQUALLY DRILLED		
	D40*T20*H(M12*1.25)*W5.5*X3	SIMON	D50.3*T14.3*H15.88*W6.25*X1.6
	D50*T20*H24*W5*X4	AGANATI	D50*T22*H28*W3.5*X3
ISOWA	D50*T10*H16*W7*X3		D70*T10*H10*W3*X2
	D50*T13*H17*W6*X3	LATITUDE	D50*T20*H15*W7*X5