

Taper Cup Grinding-wheels (Taper Cup Grinding-wheels No.2)

Written by YingLong

Monday, 09 October 2006 00:33 - Last Updated Friday, 17 September 2010 17:27

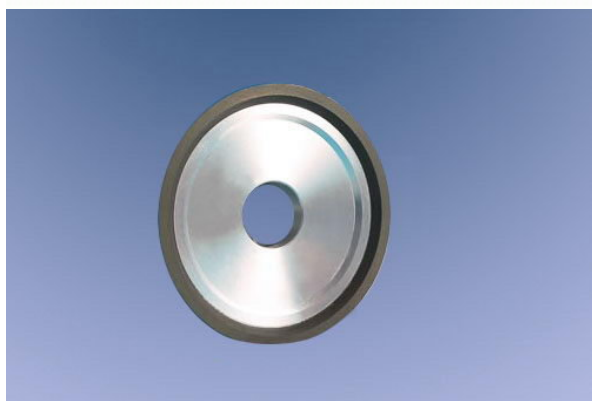
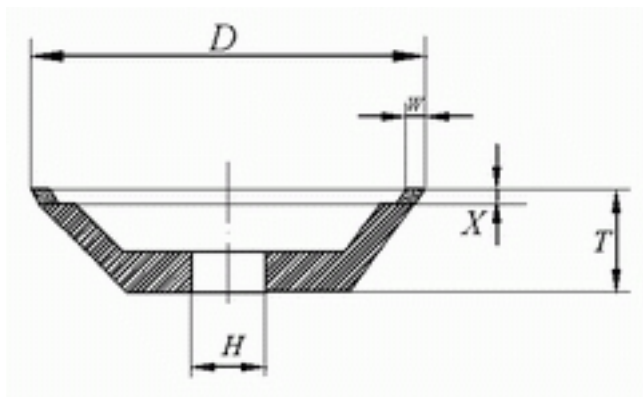

Taper Cup wheels
(Taper Cup wheels No.2)
Code:11V9(BW2)
Binder:B.M(S.Q)
 $a=0.5\text{mm}$

Size(mm)

Diamond/CBN Content (carat/piece)

Taper Cup Grinding-wheels (Taper Cup Grinding-wheels No.2)

Written by YingLong

Monday, 09 October 2006 00:33 - Last Updated Friday, 17 September 2010 17:27

D

T

H

W

X

50

75

100

80

32

20

3

Taper Cup Grinding-wheels (Taper Cup Grinding-wheels No.2)

Written by YingLong

Monday, 09 October 2006 00:33 - Last Updated Friday, 17 September 2010 17:27

5

7.79

11.68

15.58

100

40

20

3.5

7

15.91

23.86

31.81

Taper Cup Grinding-wheels (Taper Cup Grinding-wheels No.2)

Written by YingLong

Monday, 09 October 2006 00:33 - Last Updated Friday, 17 September 2010 17:27

125

40

32

4

7

22.91

34.37

45.82

150

40

32

5

Taper Cup Grinding-wheels (Taper Cup Grinding-wheels No.2)

Written by YingLong

Monday, 09 October 2006 00:33 - Last Updated Friday, 17 September 2010 17:27

7

34.44

51.66

68.88